



18V Brushless Auto Shut-Off Open End & Close End Wrenches



Switch With Simple Operation

Quickly double-click to switch forward and reverse. Different colors indicate working status.

Status Indicator

- **Green Light:** Indicates that locking is complete.
- **Red Light:** Abnormal locking, may not reach the torque or the screw has been locked.
- **Yellow Light:** Low battery
- **Green & Red Light Flashing:** Under reversing

Trigger for Durable Usage

Ergonomic Design

Ergonomic design for comfortable usage & light weight.



LED Light

Industrial Brushless Motor

Industrial brushless motor, maintenance-free.

High-Precision Clutch Mechanism

New 18V Li-Ion Battery

New Li-Ion Battery provides longer operation time

Contents:

- 2pcs 2.5Ah Li-ion Battery
- 1pcs 18V Charger

SEIW1800V-A15-BTR

18V Battery

- High-Performance Industrial Battery



Close End



Open End



Short Arm



Long Arm



SEIW1800V-A15-CHG

18V Charger

- Rapid rechargeable technology allows the battery to be fully charged with in 45 minutes.

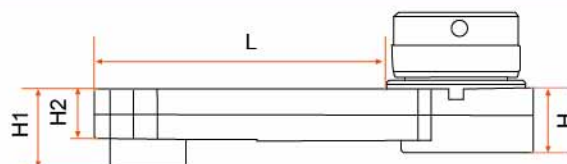
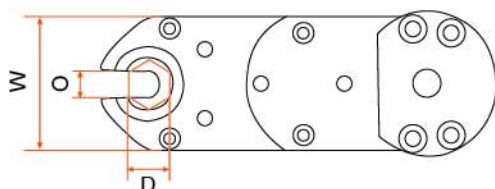

Model No.	Dimensions						
	W	H1	H2	L	D	O	H
SERW1800V-15(35)AC(AO)	38.5	21	13	30	8 - 13	6-10.2	16.8
SERW1800V-15(35)AC(AO) L	38.5	21	13	80	8 - 13	6-10.2	16.8

Model No.	Hex. Size	Voltage	Torque Range	Free Speed	Net Weight (w/o Battery)	Length	Capacity	Vibration	Noise Level
	六角尺寸	電壓	扭力範圍	無負載轉速	重量	長度		震動值	噪音值
	mm	V	Nm	R.P.M	KG	mm	mm	m/s ²	dA(B)

Brushless Auto Shut-Off Open End Wrenches (L: Long Arm)

SERW1800V-15AO(L)	8,9,10,11,12,13	18V	3 - 11	450	1.7	510	M4-M6	<2.5	<75
SERW1800V-35AO(L)	8,9,10,11,12,13	18V	11 - 26	200	2.1	595	M6-M8	<2.5	<75

Brushless Auto Shut-Off Close End Wrenches (L: Long Arm)

SERW1800V-15AC(L)	8,9,10,11,12,13	18V	3 - 11	450	1.7	510	M4-M6	<2.5	<75
SERW1800V-35AC(L)	8,9,10,11,12,13	18V	11 - 26	200	2.1	595	M6-M8	<2.5	<75



AIRPRO INDUSTRY CORP.

6F-2 No.158 Kancheng Rd.,Panchiao District,New Taipei City, Taiwan 22061

E-mail:sales@airprotool.com / sales@airprowu.com

Tel No : 886-2-29504785 Fax No : 886-2-89533145

www.airprotool.com Skype : airprotool





18V Brushless Auto Shut-Off Angle Screwdrivers & Wrenches



■ Switch With Simple Operation

Quickly double-click to switch forward and reverse. Different colors indicate working status.

■ Industrial Brushless Motor

Industrial brushless motor, maintenance-free.

■ High-Precision Clutch Mechanism

■ New 18V Li-Ion Battery

New Li-Ion Battery provides longer operation time.

Contents:

- 2pcs 2.5Ah Li-ion Battery
- 1pcs 18V Charger

■ Ergonomic Design

Ergonomic design for comfortable usage & light weight.

■ Trigger for Durable Usage

■ LED Light

Adjustable Angle For More Comfortable Operation

Status Indicator

- **Green Light:** Indicates that locking is complete.
- **Red Light:** Abnormal locking, may not reach the torque or the screw has been locked.
- **Yellow Light:** Low battery
- **Green & Red Light Flashing:** Under reversing



SEIW1800V-A15-CHG

18V Charger

- Rapid rechargeable technology allows the battery to be fully charged within 45 minutes.



SEIW1800V-A15-BTR

18V Battery

- High-Performance Industrial Battery



Compliance with ISO 5393 (CMK ≥ 1.67 at $\pm 10\%$)

Model No.	Square Drive	Voltage	Torque Range	Free Speed	Net Weight (w/o Battery)	Length	Capacity	Vibration	Noise Level	Battery
	套筒/起子	電壓	扭力範圍	無負載轉速	重量	長度		震動值	噪音值	
	Inch	V	Nm	R.P.M	KG	mm	mm	m/s ²	dA(B)	

Brushless Auto Shut-Off Angle Screwdrivers

SESC1800V-A15	Hex.1/4"	18V	4 - 15	450	1.2	430	M4-M6	<2.5	<75	Li - Ion
---------------	----------	-----	--------	-----	-----	-----	-------	------	-----	----------

Brushless Auto Shut-Off Angle Wrenches

SEIW1800V-A15	Sq. 3/8"	18V	4 - 15	450	1.2	430	M4-M6	<2.5	<75	Li - Ion
SEIW1800V-A25	Sq. 3/8"	18V	8 - 25	260	1.6	515	M6-M8	<2.5	<75	Li - Ion
SEIW1800V-A35	Sq. 3/8"	18V	15 - 35	200	1.6	515	M6-M8	<2.5	<75	Li - Ion
SEIW1800V-A45	Sq. 3/8"	18V	25 - 45	160	1.6	515	M6-M10	<2.5	<75	Li - Ion



AIRPRO INDUSTRY CORP.

6F-2 No.158 Kancheng Rd., Panchiao District, New Taipei City, Taiwan 22061

E-mail: sales@airprotool.com / sales@airprowu.com

Tel No : 886-2-29504785 Fax No : 886-2-89533145

www.airprotool.com Skype : airprotool





18V Brushless Auto Shut-Off Screwdrivers



■ High-Precision Clutch Mechanism

■ LED Light

■ New 18V Li-Ion Battery

New Li-Ion Battery provides longer operation time

Contents:

- 2pcs 2.5Ah Li-ion Battery
- 1pcs 18V Charger

SEIW1800V-A15-BTR

18V Battery

- High-Performance Industrial Battery



■ Industrial Brushless Motor

Industrial brushless motor, maintenance-free, electronic precision control protecting motor operation.

Status Indicator

- **Green Light:** Indicates that locking is complete.
- **Red Light** : Abnormal locking, may not reach the torque or the screw has been locked.
- **Yellow Light:** Low battery
- **Green & Red Light Flashing:** Under reversing



■ Reverse Switch

SEIW1800V-A15-CHG

18V Charger

- Rapid rechargeable technology allows the battery to be fully charged with in 45 minutes.



Compliance with ISO 5393 (CMK ≥ 1.67 at $\pm 10\%$)

Model No.	Square Drive	Voltage	Torque Range	Free Speed	Net Weight (w/o Battery)	Length	Capacity	Vibration	Noise Level	Battery
	起子	電壓	扭力範圍	無負載轉速	重量	長度		震動值	噪音值	
	Inch	V	Nm	R.P.M	KG	mm		m/s ²	dA(B)	
SEID1800V-E6	Hex.1/4	18	1 - 6	900	0.8	187	M3-M5	<2.5	<75	Li - Ion
SEID1800V-E9	Hex.1/4	18	1.5 - 9	700	0.8	187	M3-M5	<2.5	<75	Li - Ion
SEID1800V-E12	Hex.1/4	18	2 - 12	500	0.8	187	M4-M6	<2.5	<75	Li - Ion



AIRPRO INDUSTRY CORP.

6F-2 No.158 Kancheng Rd.,Panchiao District,New Taipei City, Taiwan 22061

E-mail:sales@airprotool.com / sales@airprowu.com

Tel No : 886-2-29504785 Fax No : 886-2-89533145

www.airprotool.com Skype : airprotool

